

Parcel Map 10236

Map Bk 330

PP 14-15

OWNER'S STATEMENT

THE UNDERSIGNED HEREBY STATES THAT WE ARE THE OWNER OF THE LAND DELINEATED AND EMBRACED WITHIN THE EXTERIOR BOUNDARY LINES ON THE HEREIN EMBODIED MAP ENTITLED "PARCEL MAP NO. 10236". THAT SAID OWNER CONSENTS TO THE PREPARATION AND FILING OF THIS MAP.

THIS MAP SHOWS ALL THE EASEMENTS ON THE PREMISES, OR OF RECORD.

OWNER: KENT WAI LAU

BY: Kent Wai Lau

DATE: Oct 30, 2014

OWNER'S ACKNOWLEDGEMENT

STATE OF CALIFORNIA _____
COUNTY OF Alameda) SS

ON Oct. 30, 2014, BEFORE ME, Patrick Siu, Notary Public
(HERE INSERT NAME AND TITLE OF THE OFFICER)

PERSONALLY APPEARED Kent Wai Lau
WHO PROVED TO ME ON THE BASIS OF SATISFACTORY EVIDENCE TO BE THE PERSON(S) WHOSE NAME(S) IS/ARE SUBSCRIBED TO THE WITHIN INSTRUMENT AND ACKNOWLEDGED TO ME THAT HE/SHE/THEY EXECUTED THE SAME IN HIS/HER/THEIR AUTHORIZED CAPACITY(IES) AND THAT BY HIS/HER/THEIR SIGNATURE(S) ON THE INSTRUMENT THE PERSON(S), OR THE ENTITY UPON BEHALF OF WHICH THE PERSON(S) ACTED, EXECUTED THE INSTRUMENT.

I CERTIFY UNDER PENALTY OF PERJURY UNDER THE LAWS OF THE STATE OF CALIFORNIA THAT THE FOREGOING PARAGRAPH IS TRUE AND CORRECT.

WITNESS MY HAND AND OFFICIAL SEAL.

SIGNATURE: Patrick Siu

PRINTED NAME: Patrick Siu

COMMISSION NUMBER: 1983247

COMMISSION EXPIRES: June 24, 2016

PRINCIPAL PLACE OF BUSINESS: Alameda COUNTY

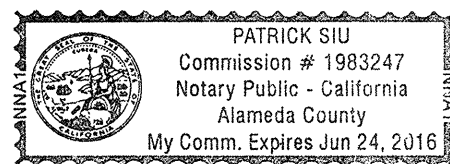

SURVEYOR'S STATEMENT

THIS MAP WAS PREPARED BY ME OR UNDER MY DIRECTION AND IS BASED UPON A FIELD SURVEY IN CONFORMANCE WITH THE REQUIREMENTS OF THE SUBDIVISION MAP ACT AND LOCAL ORDINANCE AT THE REQUEST OF KENT WAI LAU IN JULY 12, 2013. I HEREBY STATE THAT THIS PARCEL MAP SUBSTANTIALLY CONFORMS TO THE APPROVED OR CONDITIONALLY APPROVED TENTATIVE MAP, IF ANY. I HEREBY STATE THAT THE MONUMENTS ARE OF THE CHARACTER SHOWN AND OCCUPY THE POSITIONS INDICATED AND ARE SUFFICIENT TO ENABLE THE SURVEY TO BE RETRACED.

Barry A. Pierce
BARRY A. PIERCE, P.L.S. 6975
LICENSE EXPIRES 09-30-2015

DATE: 10.1.14



PARCEL MAP No. 10236

BEING A TWO LOT SUBDIVISION OF THOSE PARCELS OF LAND DESCRIBED IN THAT CERTAIN GRANT DEED RECORDED DECEMBER 3, 2012 OF THE SOUTHWESTERLY 48 FEET OF LOT 3 IN BLOCK 20 AS SAID LOT & BLOCK ARE SHOWN ON THE MAP ENTITLED "MAP OF BROADMOOR, ALAMEDA COUNTY" FILED JANUARY 30, 1908 IN BOOK 23 OF MAPS AT PAGE 68, ALAMEDA COUNTY REOCRDS (A.P.N.: 076-0299-39), UNDER INSTRUMENT NUMBER: 54605-1203811-12 (NAT), ALL OFFICIAL RECORDS OF ALAMEDA COUNTY.

CITY OF SAN LEANDRO - ALAMEDA COUNTY - CALIFORNIA
OCTOBER 2014



TRANSAMERICAN ENGINEERS
1390 Market St., Suite 201
San Francisco, CA 94102
Phone No. (415) 553-4092
Fax No. (415) 553-4071

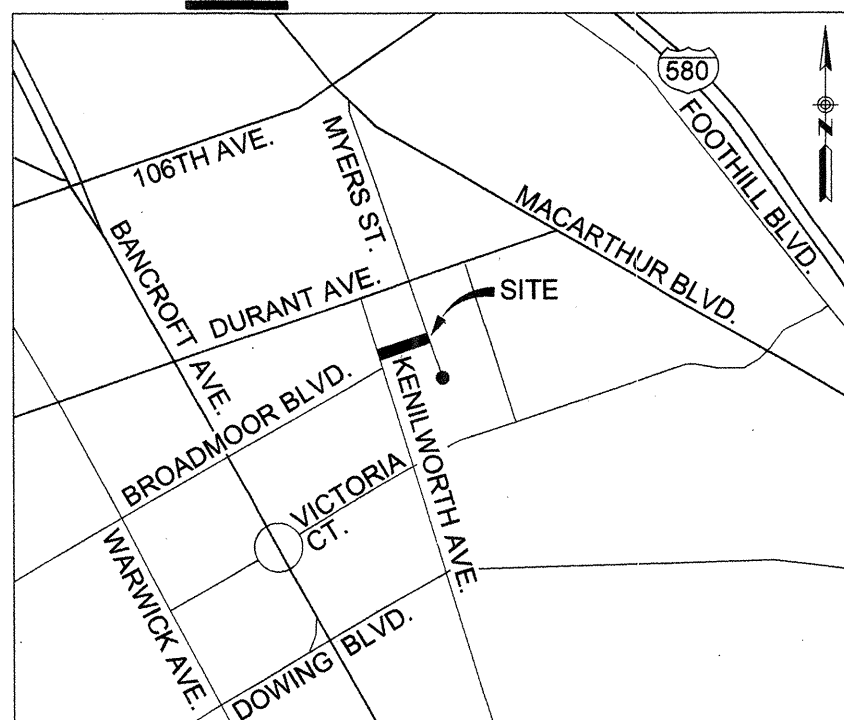

VICINITY MAP

NOT TO SCALE

CITY SURVEYOR'S STATEMENT

I, FRANK C. BELLECCI, CITY SURVEYOR FOR THE CITY OF SAN LEANDRO, DO HEREBY STATE THAT I HAVE EXAMINED THE HEREIN EMBODIED PARCEL MAP ENTITLED "PARCEL MAP 10236", CONSISTING OF TWO (2) SHEETS, THIS STATEMENT BEING ON SHEET ONE (1) THEREOF, AND THAT THE SURVEY DATA SHOWN UPON SAID MAP IS TECHNICALLY CORRECT.

Frank C. Bellecci 11-07-14
FRANK C. BELLECCI, L.S. 5399
REGISTRATION EXPIRES: 9/30/2016
CITY SURVEYOR, CITY OF SAN LEANDRO,
ALAMEDA COUNTY, CALIFORNIA

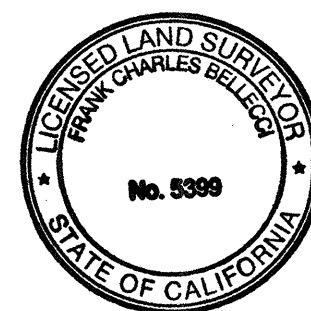

CITY ENGINEER'S STATEMENT:

I, KENNETH JOSEPH, CITY ENGINEER OF THE CITY OF SAN LEANDRO, COUNTY OF ALAMEDA, STATE OF CALIFORNIA, DO HEREBY STATE AS FOLLOWS:

- 1) THAT I HAVE EXAMINED THE HEREIN EMBODIED PARCEL MAP ENTITLED "PARCEL MAP 10236", CONSISTING OF TWO (2) SHEETS, THIS STATEMENT BEING ON SHEET ONE(1) THEREOF.
- 2) THE SUBDIVISION AS SHOWN UPON SAID PARCEL MAP IS SUBSTANTIALLY THE SAME AS SAID SUBDIVISION APPEARED ON THE TENTATIVE MAP, IF REQUIRED, AND ANY APPROVED ALTERATION THEREOF.
- 3) ALL PROVISIONS OF THE SUBDIVISION MAP ACT OF THE STATE OF CALIFORNIA AND AMENDMENTS THERETO AND ANY LOCAL ORDINANCE APPLICABLE AT THE TIME OF APPROVAL OF THE TENTATIVE MAP, IF REQUIRED, HAVE BEEN COMPLIED WITH.

IN WITNESS THEREOF, I HAVE HEREUNTO SET MY HAND THIS 25th DAY OF November 2014

Kenneth C. Joseph
KENNETH C. JOSEPH R.C.E. NO. 34870
REGISTRATION EXPIRES: 09-30-2015
CITY ENGINEER FOR THE CITY OF SAN LEANDRO,
ALAMEDA COUNTY, CALIFORNIA

DATE: 11/25/2014



CERTIFICATE OF CLERK OF BOARD OF SUPERVISOR:

I, ANIKA CAMPBELL-BELTON, CLERK OF THE BOARD OF SUPERVISORS FOR THE COUNTY OF ALAMEDA, STATE OF CALIFORNIA, DO HEREBY CERTIFY, AS CHECKED BELOW THAT:

☒ AN APPROVED ~~DEED~~ ^{check} ~~DEED~~ HAS BEEN FILED WITH THE SUPERVISOR OF THE SAID COUNTY AND STATE IN THE AMOUNT OF \$4,043. ¹⁰⁴³ ~~1043~~ CONDITIONED FOR PAYMENT OF ALL TAXES AND SPECIAL ASSESMENTS COLLECTED AS TAXES WHICH ARE NOW A LIEN AGAINST SAID LAND OF ANY PART THEREOF BUT NOT YET PAYABLE AND WAS DULY APPROVED BY SAID BOARD IN SAID AMOUNT.

☐ ALL TAXES AND SPECIAL ASSESMENTS COLLECTED AS TAXES HAVE BEEN PAID AS CERTIFIED BY THE TREASURER TAX COLLECTOR OF THE COUNTY OF ALAMEDA/

ANIKA CAMPBELL-BELTON
CLERK OF THE BOARD OF
SUPERVISORS FOR THE COUNTY OF ALAMEDA,
STATE OF CALIFORNIA

DATE: 4/28/15
\$4,043.- cc

BY: Anika Campbell-Belton
DEPUTY CLERK



CITY CLERK'S STATEMENT

I, MARIAN HANDA CITY CLERK AND CLERK OF THE COUNCIL OF THE CITY OF SAN LEANDRO, COUNTY OF ALAMEDA, STATE OF CALIFORNIA, DO HEREBY STATE THAT THE HEREIN EMBODIED PARCEL MAP ENTITLED "PARCEL MAP 10236", CONSISTING OF TWO (2) SHEETS, THIS STATEMENT BEING ON SHEET ONE (1) THEREOF, WAS PRESENTED TO SAID COUNCIL OF THE CITY OF SAN LEANDRO AS PROVIDED BY LAW, AT THE REGULAR MEETING HELD ON THE 15th DAY OF DECEMBER, 2014 AND THAT SAID DULY PASSED AND ADOPTED AT SAID MEETING, APPROVE SAID MAP.

IN WITNESS WHEREOF, I HAVE HEREUNTO SET MY HAND THIS 2ND DAY OF DECEMBER 2014

Marian Handa
MARIAN HANDA
CITY CLERK AND CLERK OF THE CITY COUNCIL
OF THE CITY OF SAN LEANDRO,
ALAMEDA COUNTY,
STATE OF CALIFORNIA

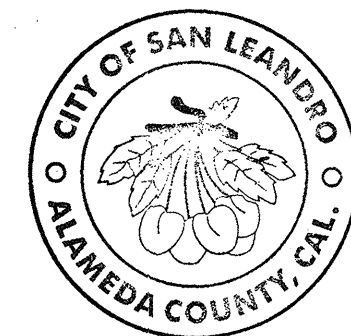

RECORDER'S STATEMENT

FILED THIS 21st DAY OF July, 2015 AT 10:17 A.M.
IN BOOK 330 OF PARCEL MAPS, AT PAGES PP 14-15
AT THE REQUEST OF North American title

FEE: \$11.00 SERIES NUMBER: 2015200479
~~PATRICK O'CONNELL~~ STEVE MANNING
COUNTY RECORDER IN AND FOR THE COUNTY
OF ALAMEDA, STATE OF CALIFORNIA

BY: Kelly Gram
DEPUTY COUNTY RECORDER

