

RECORD of SURVEY

for

**THERESA LYNN RETTINGHOUSE and
JAMES NICKOLAS DAVID RETTINGHOUSE**
20180007836

BEING A PORTION OF THE NE 1/4 SECTION 29, T. 7 N., R. 13 E., M. D. M.
COUNTY OF AMADOR, STATE OF CALIFORNIA

PARCEL 4A
13-M-39
HELMLE TRUST
1998001246

Toma & Associates Inc.
ENGINEERING - SURVEYING - PLANNING
41 Summit Street, Jackson, CA 95642
(209) 223-0156

Scale: 1" = 100'

December, 2018

PARCEL 4B
13-M-39

AUSTIN
398-OR-382

PARCEL 4
11-M-75
TRUJILLO TRUST
2001006006

CLEE/RANDOLPH
2012005456

ZIPSE
2002000093

PARCEL A
14.34 Acres

PARCEL B
62-M-97
KELLY
2010003671

45-M-33
GARDNER
2012003424

N 89°15'13" E(3)
TIE S 89°41'58" W 391.29'

WEST(2)
N 89°15'13" E(3)
S 89°41'58" W 600.00'(2)

S.20 S.21
S.29 S.28

S 01°33'00" W 1023.11'(2)
S 01°36'21" W 1008.96'

BASIS OF BEARINGS
TIE S 04°20'27" W(1) 1026.62'(M)
1026.30'(1)
S 01°33'00" W 1313.11'(1)(2) TOTAL

FND. 5/8" REBAR,
NO TAG
S 88°45'20" E 550.69'
S 88°46'00" E 550.77'(1)

N 01°45'01" E 290.00'(1)
N 01°49'22" E 290.03'

S 01°33'00" W(1)
S 01°32'43" W 289.18'(1)

27.00'(1) 50.00'(1)

S 89°52'32" W
N 90°00'00" W(1)

STATE HIGHWAY 88

TO BUCKHORN

SURVEYOR'S STATEMENT

THIS MAP CORRECTLY REPRESENTS A SURVEY MADE BY ME OR UNDER MY DIRECTION IN CONFORMANCE WITH THE REQUIREMENTS OF THE PROFESSIONAL LAND SURVEYORS ACT AT THE REQUEST OF THERESA RETTINGHOUSE IN JULY OF 2018.

DATE: DECEMBER 12, 2018

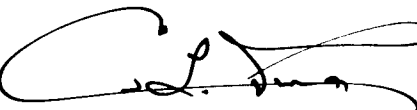
CIRO L. TOMA P.L.S. 3570
MY LICENSE EXPIRES 6-30-2020

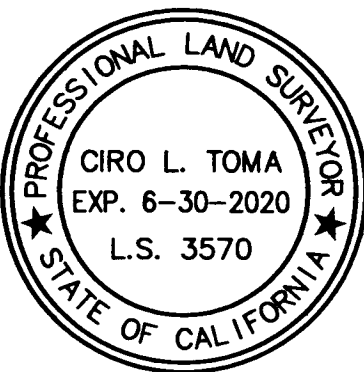

COUNTY SURVEYOR'S STATEMENT

THIS MAP HAS BEEN EXAMINED IN ACCORDANCE WITH SECTION 8766 OF THE PROFESSIONAL LAND SURVEYORS ACT THIS 14TH DAY OF DECEMBER, 2018.

STEVEN A. ZANETTA PLS 6245
AMADOR COUNTY SURVEYOR
MY LICENSE EXPIRES 3-31-2020



RECORDER'S STATEMENT

FILED THIS 18TH DAY OF December, 2018, AT 1:43 P.M.
IN BOOK 65 OF MAPS AND PLATS AT PAGE 86 AT THE REQUEST OF
THE AMADOR COUNTY SURVEYOR.

FEE: \$100 pd/filed

INSTRUMENT No.: 2018-0009169

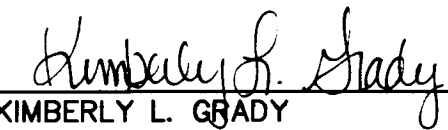
KIMBERLY L. GRADY
AMADOR COUNTY RECORDER

BY: 
DEPUTY

NOTES and LEGEND

- DENOTES 3/4" REBAR WITH PLASTIC CAP STAMPED PLS 3570 SET ON THIS SURVEY
- DENOTES FOUND 1-1/2" BRASS CAPPED IRON PIPE AT SECTION CORNER PER 24-M-30
- ⊗— DENOTES FOUND 5/8" REBAR WITH CAP STAMPED LS 5257 PER 62-M-97, UNLESS OTHERWISE NOTED
- ⊗— DENOTES FOUND 2" BRASS CAPPED IRON PIPE
- DENOTES FOUND 3/4" REBAR TAGGED LS 3570 PER 62-M-97
- (1) DENOTES RECORD DATA PER 62-M-97
- (2) DENOTES RECORD DATA PER 24-M-30
- (3) DENOTES RECORD DATA PER 7-M-49

BASIS OF BEARINGS IS REFERRED TO A CALCULATED TIE BETWEEN FOUND MONUMENTS AS SHOWN ON 62-M-97, THE BEARING OF WHICH IS S 04°20'27" W.