

STORM STRUCTURE TABLE				
STRUCTURE NAME	STRUCTURE TYPE	RIM ELEVATION	INVERT IN	INVERT OUT
A0	WQ UNIT STUB-IN	657.85	652.50 (PA1)	
A1	JUNCTION BOX DETAIL 5, SHEET C04.3	657.62	652.85 (PA1.1) 652.85 (PA2)	652.85 (PA1)
A1.1	CURB INLET DETAIL 2, SHEET C04.4	657.45	653.20 (PA1.2)	653.01 (PA1.1)
A1.2	CURB INLET DETAIL 2, SHEET C04.4	660.00		655.00 (PA1.2)
A2	JUNCTION BOX DETAIL 5, SHEET C04.3	657.41	653.19 (PA3)	652.99 (PA2)
A3	JUNCTION BOX DETAIL 5, SHEET C04.3	657.29	653.74 (PA4) 653.74 (PA3.1)	653.54 (PA3)
A3.1	CURB INLET DETAIL 2, SHEET C04.4	657.79		653.89 (PA3.1)
A4	DROP GRATE INLET DETAIL 1, SHEET C04.4	660.67	655.54 (PA5)	655.34 (PA4)
A5	CURB INLET DETAIL 2, SHEET C04.4	660.94		655.61 (PA5)

STORM PIPE TABLE				
PIPE NAME	SIZE	LENGTH	SLOPE	MATERIAL
PA1	18"	15.09'	1.00%	HDPE
PA1.1	18"	15.42'	1.00%	HDPE
PA1.2	18"	179.35'	1.00%	HDPE
PA2	18"	13.46'	1.00%	HDPE
PA3	18"	35.71'	1.00%	HDPE
PA3.1	18"	14.37'	1.00%	HDPE
PA4	18"	159.71'	1.00%	HDPE
PA5	18"	6.64'	1.00%	HDPE

SANITARY PIPE TABLE				
PIPE NAME	SIZE	LENGTH	SLOPE	MATERIAL
PS1	6"	68.69'	2.80%	PVC
PS2	6"	31.93'	2.75%	PVC
PS3	6"	50.00'	2.75%	PVC
PS4	6"	50.01'	2.75%	PVC
PS5	6"	55.23'	2.75%	PVC
PS5.1	6"	6.33'	1.83%	PVC
PS5.2	6"	21.08'	1.85%	PVC
PS5.3	6"	14.55'	1.85%	PVC
PS5.4	6"	15.28'	1.85%	PVC
PS5.5	6"	5.01'	1.85%	PVC
PS6	6"	5.00'	2.00%	PVC
PS7	6"	5.00'	2.00%	PVC
PS8	6"	21.25'	2.00%	PVC
PS9	6"	13.32'	2.00%	PVC
PS10	6"	3.01'	2.00%	PVC

SANITARY STRUCTURE TABLE				
STRUCTURE NAME	STRUCTURE TYPE	RIM ELEVATION	INVERT IN	INVERT OUT
ES0	EXISTING SEWER MANHOLE	659.20	649.43 (PS1)	
S1	6" CLEANOUT	659.51	651.35 (PS2)	651.35 (PS1)
S2	6" CLEANOUT	660.24	652.23 (PS3)	652.23 (PS2)
S3	6" CLEANOUT	661.83	653.60 (PS4)	653.60 (PS3)
S4	6" CLEANOUT	663.78	654.98 (PS5)	654.98 (PS4)
S5	6" CLEANOUT	661.08	656.50 (PS6) 656.50 (PS5.1)	656.50 (PS5)
S5.1	6" CLEANOUT	661.00	656.62 (PS5.2)	656.62 (PS5.1)
S5.2	6" CLEANOUT	661.00	657.00 (PS5.3)	657.00 (PS5.2)
S5.3	6" CLEANOUT	660.58	657.27 (PS5.4)	657.27 (PS5.3)
S5.4	6" CLEANOUT	660.56	657.56 (PS5.5)	657.56 (PS5.4)
S5.5	6" CLEANOUT	660.48		657.65 (PS5.5)
S6	GREASE TRAP	661.00		
S6 IN	GREASE TRAP IN	661.00	656.80 (PS7)	
S6 OUT	GREASE TRAP OUT	661.00		656.60 (PS6)
S7	6" CLEANOUT	661.00	656.90 (PS8)	656.90 (PS7)
S8	6" CLEANOUT	660.55	657.32 (PS9)	657.32 (PS8)
S9	6" CLEANOUT	660.53	657.59 (PS10)	657.59 (PS9)
S10	BUILDING STUB OUT	660.49		657.65 (PS10)

THE CONSTRUCTION OF UNDERGROUND ELECTRICAL & TELEPHONE LINES SHALL BE GOVERNED BY THE LOCAL ELECTRICAL & TELEPHONE PROVIDERS. THIS DRAWING SHALL SERVE AS REFERENCE FOR THE CONTRACTOR TO COORDINATE THE LOCATION OF THE ELECTRICAL & TELEPHONE SERVICE WITH LOCAL PROVIDERS.

GAS MAIN TO BE EXTENDED TO THE PROPERTY BY THE UTILITY COMPANY.

THE CONSTRUCTION OF UNDERGROUND GAS SYSTEM SHALL BE GOVERNED BY THE LOCAL GAS PROVIDER. THIS DRAWING SHALL SERVE AS REFERENCE FOR THE CONTRACTOR TO COORDINATE THE LOCATION OF THE GAS SERVICE WITH LOCAL PROVIDER.

KANNAPOLIS PARKWAY
S.R. 1430
Variable Width Public R/W
(NC DOT Proj. 6-804816)

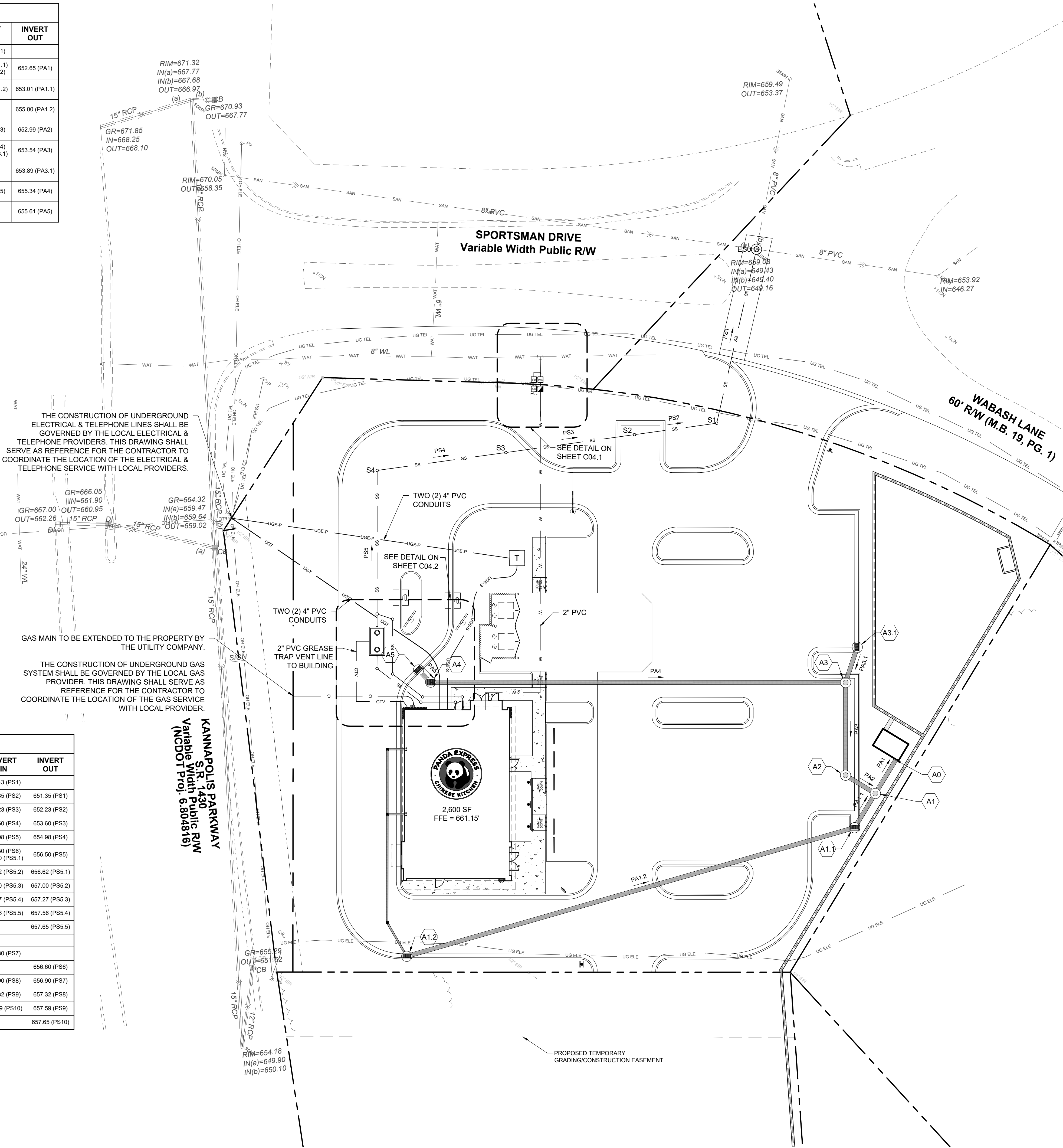

UTILITY LEGEND	
UTILITIES	LINETYPE/SYMBOL
DOMESTIC WATER LINE	DW DW
FIRE WATER LINE	FW FW
BUILDING FIRE SPRINKLER LINE	FWS FWS
IRRIGATION WATER LINE	IRR IRR
DOMESTIC WATER METER (WM)	WM
IRRIGATION METER (IRR)	IRR
BACKFLOW PREVENTER (RPZ)	RPZ
DC BACKFLOW PREVENTER	DDC
FIRE VAULT (DDC)	DDC
WATER TAP OR TEE	
GATE VALVE (GV)	GV
THRUST BLOCK (TB)	TB
FIRE HYDRANT (FH)	FH
FIRE DEPARTMENT CONNECTION (FDC)	FDC
SANITARY SEWER (SS)	SS SS
GREASE TRAP VENT LINE (GTV)	GTV GTV
SANITARY MANHOLE (SSMH)	SSMH
GENERAL CLEAN OUT (Co)	Co
SANITARY STRUCTURE NUMBER	S2
UNDERGROUND ELECTRIC LINE-PRIMARY	UGE-P UGE-P
UNDERGROUND ELECTRIC LINE-SECONDARY	UGE-S UGE-S
POST INDICATOR VALVE	PIV
SITE LIGHTING POLE	
TRANSFORMER PAD	T
METER/CT PEDESTAL	CT
UNDERGROUND TELEPHONE LINE	UGT UGT
GENERAL UTILITY CONDUIT	GU GU
GAS LINE	G G
GAS METERS	

** ALL UTILITIES SHALL BE INSTALLED ACCORDING TO UTILITY PROVIDERS AND JURISDICTION STANDARDS AND SPECIFICATIONS.

UTILITY NOTES SEE SHEET C01.1

SEE SHEET C04.1 FOR THE UTILITY RESPONSIBILITY MATRIX

CONTRACTOR SHALL FIELD VERIFY ALL EXISTING FEATURES, INCLUDING BUT NOT LIMITED TO, UTILITIES, EXISTING IMPROVEMENTS, ETC. CONTRACTOR SHALL VERIFY THEIR LOCATIONS AND ELEVATIONS PRIOR TO STARTING CONSTRUCTION AND ALERT ENGINEER TO ANY DISCREPANCIES IMMEDIATELY

North Carolina 811
www.nc811.org

24-HOUR CONTACT:
JOE CELENTO
(912) 272-4811



PANDA EXPRESS, INC.
1683 WALNUT GROVE AVE.
ROSEMEAD, CALIFORNIA 91770
TELEPHONE: 626.799.9898
FACSIMILE: 626.372.8268

All ideas, designs, arrangement and plans indicated or represented by this drawing are the property of Panda Express Inc. and were created for use on this specific project. None of these ideas, designs, arrangements or plans may be used by or disclosed to any person, firm, or corporation without the written permission of Panda Express Inc.

REVISIONS:

ISSUE DATE:

PLAN CHECK	03-08-23
BID	XX-XX-XX
CONSTRUCTION	XX-XX-XX

DRAWN BY: INGENIUM ENTERPRISES

PANDA PROJECT #: D24956
PANDA STORE #: TBD
CIVIL PROJECT #: 220148



INGENIUM ENTERPRISES, INC.
19445 SHUMARD OAK DR.
SUITE 102
LAND O LAKES, FL 34638
PHONE: (813) 387-0084
NCBES CERTIFICATE #C-4114



UTILITY PLAN

C04.0

PANDA HOME REV4