

CORNER RECORD

BK 57 PG 19

City of Livermore

Document Number CR 5987

County of Alameda, California

Brief Legal Description Monument search - Tesla Road at South Vasco Road

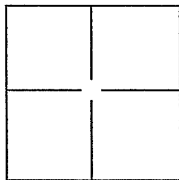

CORNER TYPE

Government Corner ☐ Control ☐
Meander ☐ Property ☐
Rancho ☐ Other ☐

Date of Survey 09/17/2013

COORDINATES(Optional)

N. _____
E. _____
Zone _____ NAD27 ☐ NAD83 ☐
NAD83 Epoch _____
Elev. _____
Vert. Datum: NGVD29 ☐ NADV88 ☐
Meas. Units: Metric ☐ Imperial ☐

Corner - Left as found ☐ Found and tagged ☐ Established ☐ Reestablished ☐ Rebuilt ☐

Identification and type of corner found: Evidence used to identify or procedure used to establish or reestablish the corner:

Alameda County monument ID #GD76J2

Post-construction corner record

A description of the physical condition of the monument as found and as set or reset: _____

Monument found - see side 2

SURVEYOR'S STATEMENT

This Corner Record was prepared by me or under my direction in conformance with
the Land Surveyor's Act on Nov 21, 2013

Signed James N. Landrum P.L.S. or R.C.E. No.: LS 5837



COUNTY SURVEYOR'S STATEMENT

This Corner Record was received 12-5-13 and examined
and filed 1-12-14

Signed Russell R. Penland P.L.S. or R.C.E. No.: 5726

Title COUNTY SURVEYOR

County Surveyor's Comment _____

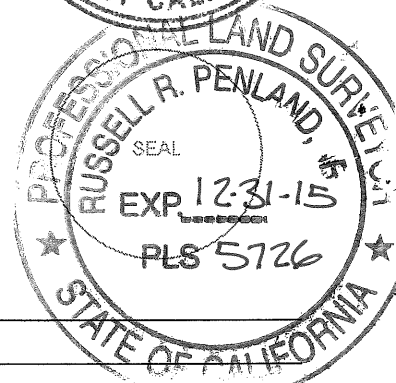

JH38W7

MONUMENT ID#GD76J2

FOUND BRASS DISK AS NOTED BELOW

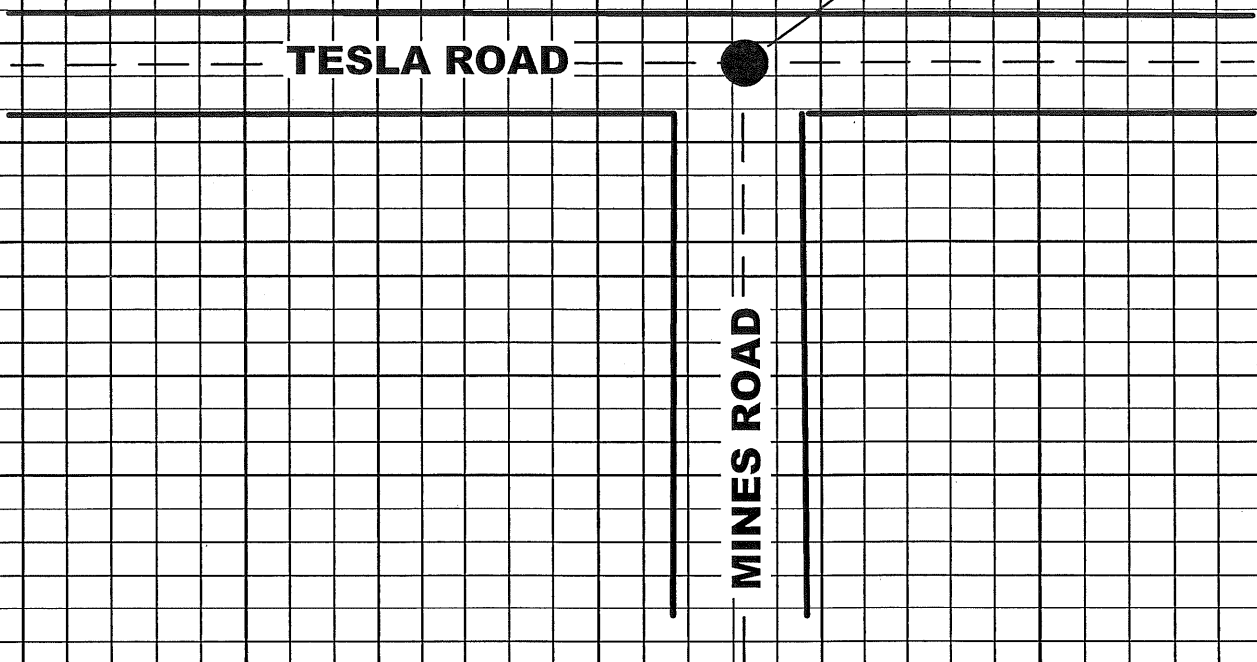

FOUND A BRASS DISK WITH PIN. STAMPING ILLEGIBLE, IN A MONUMENT WELL AT THE CENTERLINES OF THE 'T' INTERSECTION OF TESLA AND MINES ROADS ON 09/17/13. BRASS DISK APPEARS UNDISTURBED AND IS LOCATED 1.64' BELOW THE AC PAVEMENT.

LEGEND

● FD. MONUMENT

⊙ PWR POLE

⊗ SET 2' SWING TIE

⬢ BENCHMARK

— EDGE OF PAVEMENT

◐ SIGN

NOT TO SCALE

CR 5987